

Introducing the *LCBS-HT*— High Temperature Locking Circuit Board Support

Features and Benefits

- Parts operate in applications up to 392°F (200°C)
- Spaces P.C.B. off of a base or chassis in high temperature environments
- Unique locking device provides a mechanically secure connection
- One piece design eliminates the need for screws, nuts and washers
- Tension wings provide extra hold onto the chassis

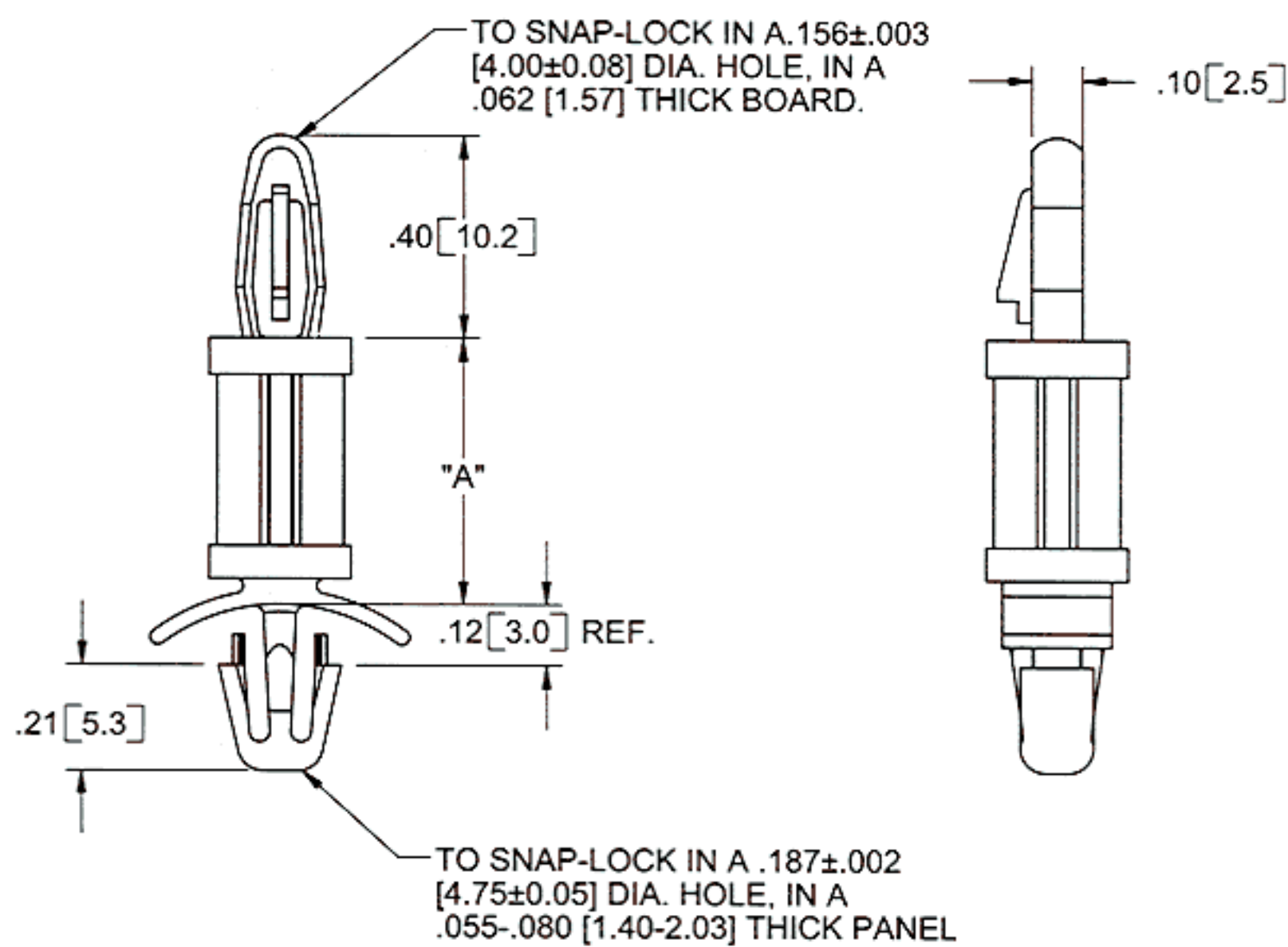
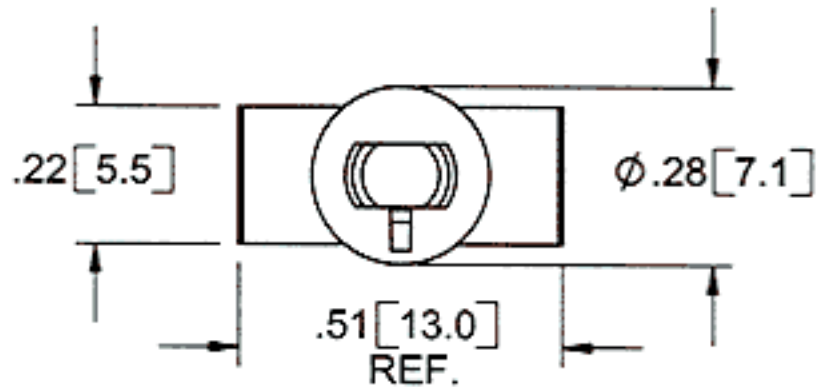

| LCBS-HT | Standard Pack: 1,000 per bag |
|--|-------------------------------------|
| Mat'l: PPHOX, RMS-162 Color: Black | Standoff Height "A" ± .014 (0.4) |
| LCBS-3-HT | 3/16 (4.8) |
| LCBS-4-HT | 1/4 (6.4) |
| LCBS-5-HT | 5/16 (7.9) |
| LCBS-6-HT | 3/8 (9.5) |
| LCBS-7-HT | 7/16 (11.1) |
| LCBS-8-HT | 1/2 (12.7) |
| LCBS-10-HT | 5/8 (15.9) |
| LCBS-12-HT | 3/4 (19.1) |
| LCBS-14-HT | 7/8 (22.2) |
| LCBS-16-HT | 1 (25.4) |
| LCBS-18-HT | 1-1/8 (28.6) |
| LCBS-20-HT | 1-1/4 (31.7) |
| LCBS-22-HT | 1-3/8 (34.9) |

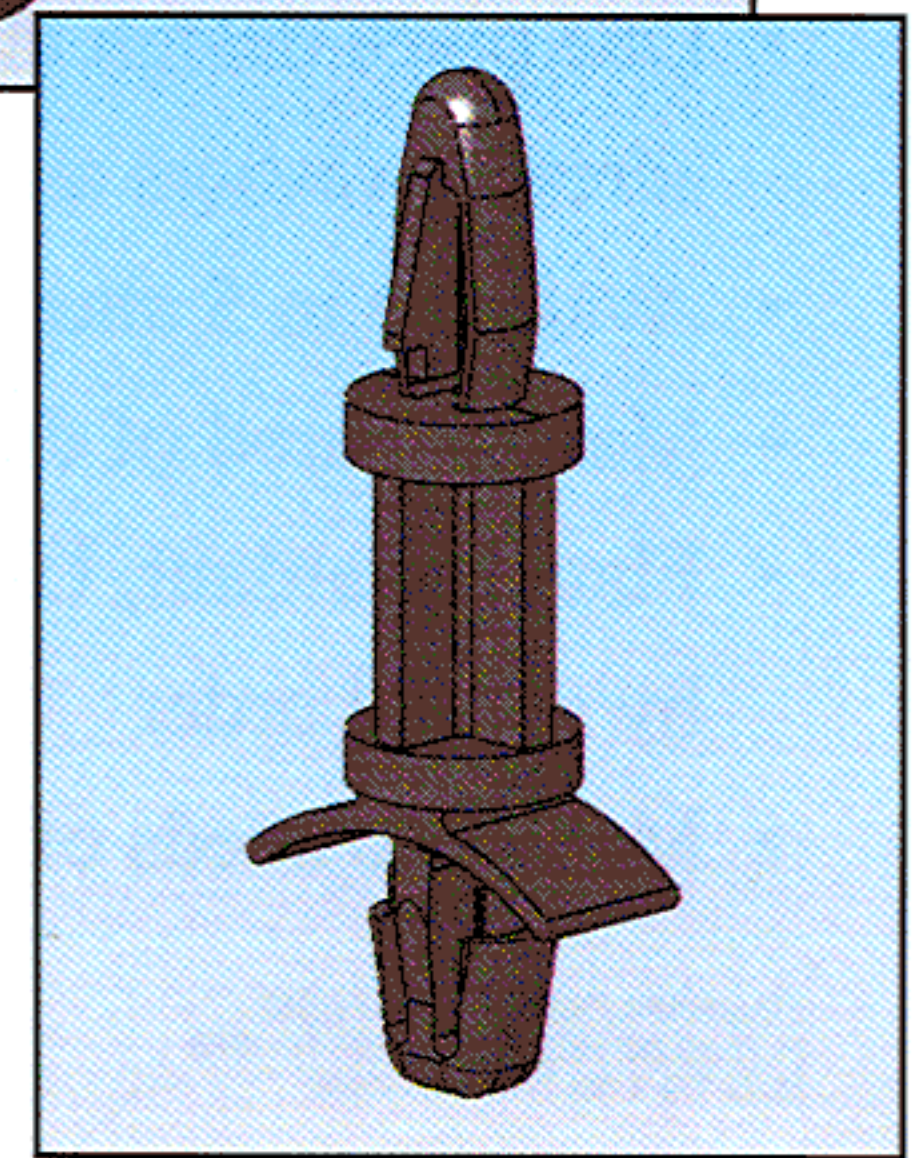
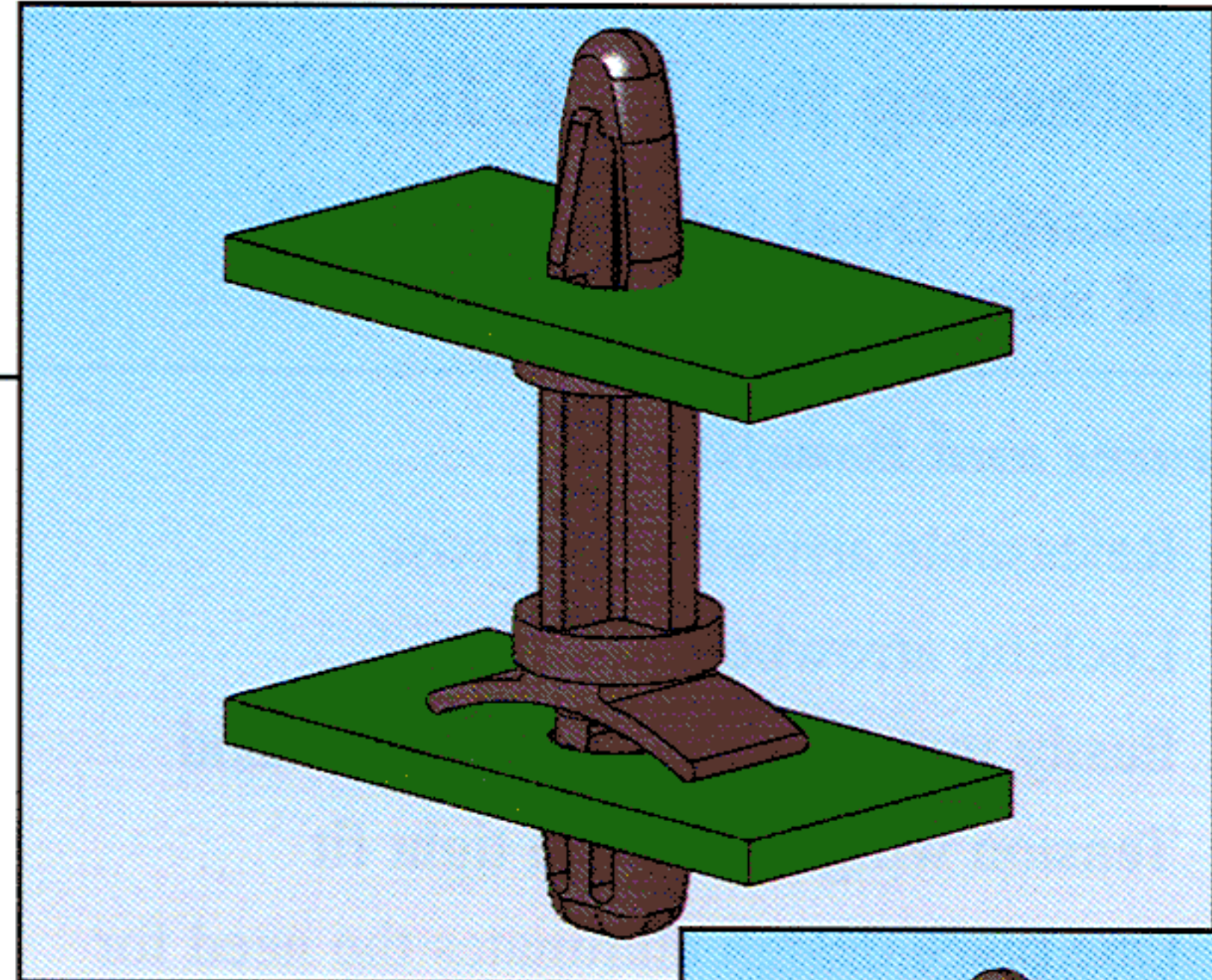

Featured
in the NEW
Edition 27 Catalog—
Available Now

Markets

- Automotive— GPS, CD and Radio Equipment
- Consumer Electronics— Audio and Video Equipment
- Security Systems— CCTV, X-Ray, Alarms and Scanning Equipment
- Office Equipment— Computers, Computer Peripherals and Photocopiers
- White Goods— Microwaves, Washing Machines, Ovens
- Telecom— Transponder/Receiver Cards, Signal Amplifier Modules

Other Related Richco Product Solutions

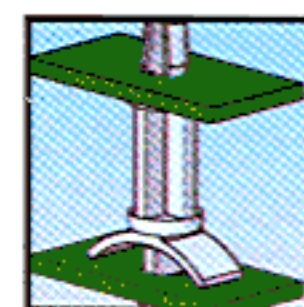

LCBS

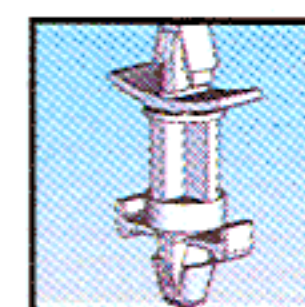

DLCBS

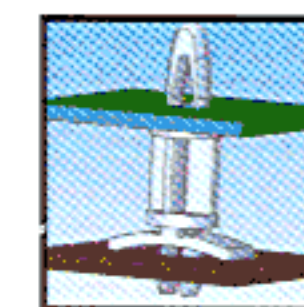

CBS

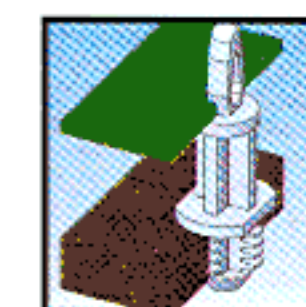

BHC

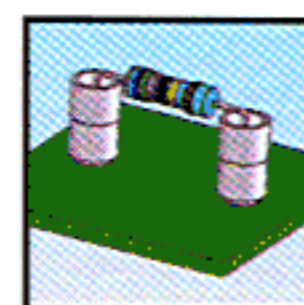

CER

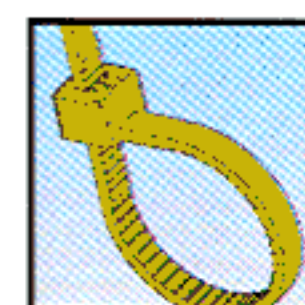

WIT-HT

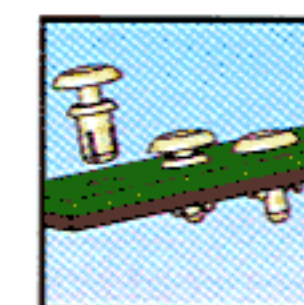

SRHR



SHR-HT