

## Introducing the **FCSE** Cable Clamp—Slide Entry

### Features and Benefits

- Clamp is removable from top side of mounting surface
- Installed by sliding one side of the clamp into a hole and snap locking the other end into a second hole
- Fits into standard .187" (4.75) hole diameters
- Designed to hold up to a 40 conductor cable width of 1.545 (39.25)
- Quick access to wires and cables

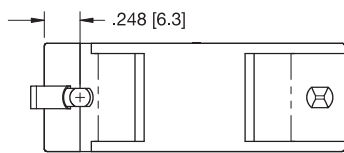
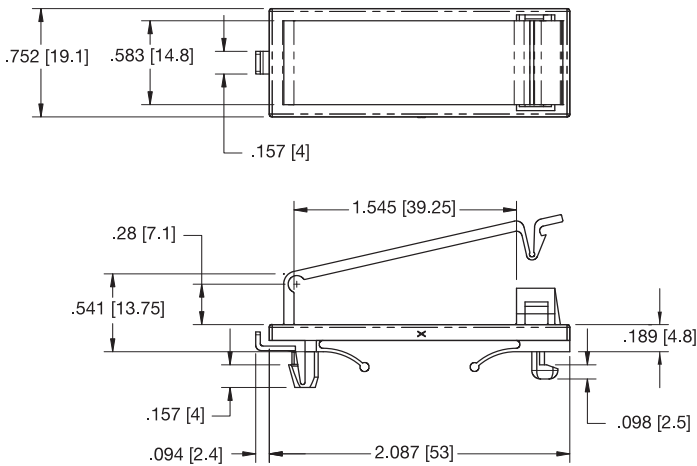
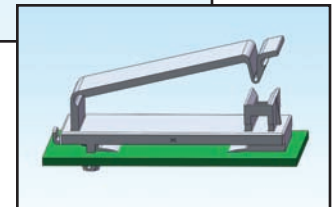
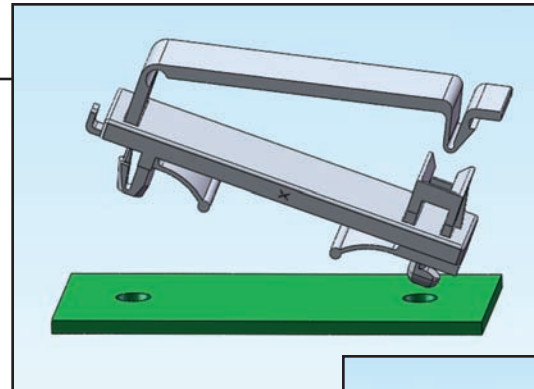

MOUNTING HOLE DETAIL

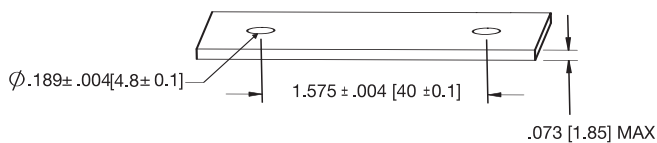

### Markets

- Telecommunications
- Appliance
- Medical Equipment
- General Electronics
- Gaming

### Other Related Richco Product Solutions



FCCA



FCCS

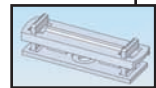

FCRC

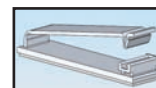

FCW



WSLTRA

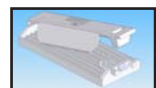

RDAFCC

### FCSE-1

Mat'l: Nylon 6/6, RMS-01\* Color: Natural

\*Parts are available in UL94 V0 material by special order only.  
To order, add -19 to the end of the part number.